

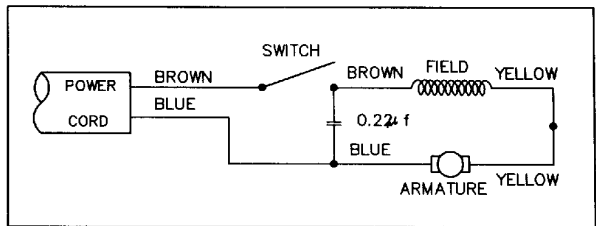

235mm Precision Power Saw SPARE PARTS LISTING

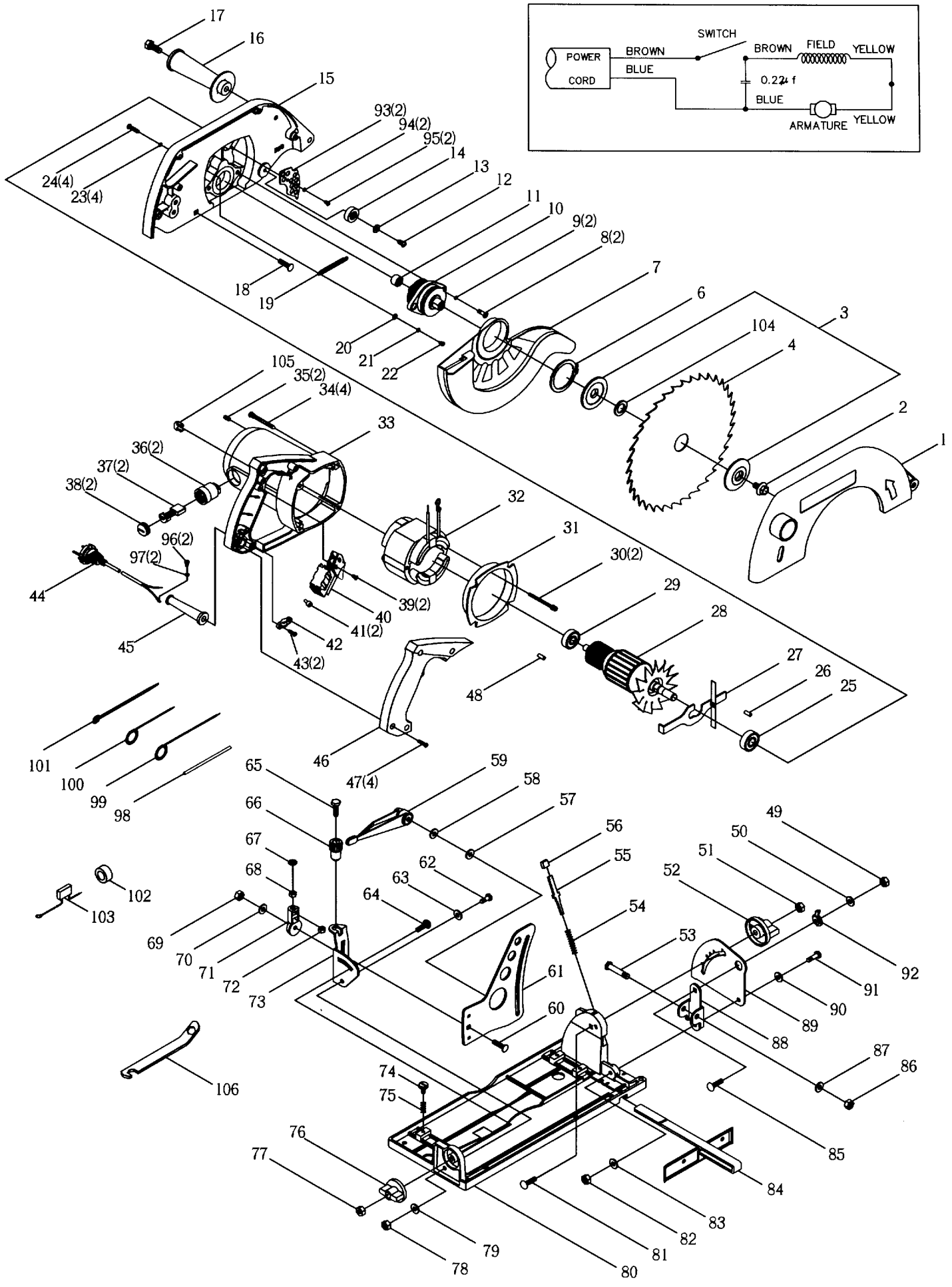

Item No.	Part No.	Description	Item No.	Part No.	Description
1	TSA019	Blade cover (labelled)	54	TSA027	Spring
1,15,23,24	TSA034	Blade housing, complete (labelled)	55	TSA007	Bevel detent latch
2	TSA044	Blade bolt	56	TSA014	Latch button
3	TSA045	Flange	57	TSA032	Fibre washer
4	TSA033	Blade, Triton 235mm 40 tooth	58	TSA039	Flat washer
6	TSA049	External retaining ring	59	TSA013	Height lever
7	TSA018	Safety cover	60	TSA028	Flat head coach bolt - M6
8	TSA050	Flat head screw M5x15	61	TSA005	Height adjustment bracket
9	TSA051	External tooth lock washer	62	TSA029	Plain shank bolt - M6
10	TSA036	Jackshaft assembly	63	CSA088	Washer - M6
11	TSA052	Needle bearing	64	CSA171	Coach bolt - M6 x 30mm
12	TSA053	Pan head screw M6x15	65	CSA240	Hex head screw - M6 x 35mm
13	TSA054	Flat washer	66	TSA010	Micro knob
14	TSA055	Cushion	67	CSA088	Washer - M6
15	TSA020	Blade housing	68	CSA090	Nyloc nut - M6
16	TSA021	Side handle	69	CSA090	Nyloc nut - M6
17	TSA056	Hex head screw M8x20	70	CSA088	Washer - M6
18	TSA030	Coach bolt (high tensile)	71	TSA011	Micro slider
19	TSA057	Return spring	72	CSA173	Hex nut - M6
20	TSA058	Flat washer	73	TSA006	Rear pivot bracket
21	TSA059	Spring lock washer	74	TSA024	Fence screw
22	TSA060	Pan head screw M4x10	75	TSA027	Spring
23	TSA061	External tooth lock washer	76	CMA038	Round knob - M6 - small
24	TSA062	Pan head screw M5x20	77	CSA090	Nyloc nut - M6
25	TSA040	Ball bearing 6201	78	CSA090	Nyloc nut - M6
26	TSA063	Rubber pin	79	CSA088	Washer - M6
27	TSA064	Lock lever	80	TSA002	Base plate
28	TSA037	Armature	81	CSA151	Coach bolt - M6 x 30mm
29	TSA041	Ball bearing 6200	82	CSA090	Nyloc nut - M6
30	TSA065	Pan head tap screw D5x60	83	CSA088	Washer - M6
31	TSA066	Fan guide	84	TSA017	Rip fence
32	TSA042	Field assembly	85	CSA241	Coach Bolt - M6 x 18mm
33	TSA022	Motor housing (labelled)	86	CSA098	Nyloc nut - M8
34	TSA067	Pan head screw M5x55	87	CSA099	Washer - M8
35	TSA068	Set screw M5x8	88	TSA003	Front pivot
36	TSA069	Brush holder	89	TSA004	Front quadrant
37	TSA043	Brush	90	CSA088	Washer - M6
38	TSA047	Brush cap	91	TSA015	Bolt - M6 - Plain shank
39	TSA070	Pan head tap screw D4x1082Sheath	92	TSA031	Blade angle adjuster
40	TSA038	Switch	93	TSA077	Cover (barrier)
41		Wire nut	94		Spring lock washer
42	TSA072	Cord clamp	95		Pan head screw M4x10
43	TSA073	Pan head tap screw D4x16	96		Pan head screw #6x6.8mm
44	TSA023	Cord & plug assy.	97		Tooth washer D3.5
45	TSA074	Guard, cord	98		Cable sleeve
46	TSA035	Handle cover	99	TSA078	Jumper wire
47	TSA075	Pan head tap screw D4x20	100	TSA079	Jumper wire
48	TSA076	Rubber pin	101		Locking cable tie
49	CSA090	Nyloc nut - M6	102	TSA080	Coil
50	TSA026	Washer - M6 - Small	103	TSA081	Capacitor
51	CSA090	Nyloc nut - M6	104	TSA012	Blade bush - 25.0mm
52	CMA047	Round knob - M6 - large	105		Sheath
53	TSA025	Bolt - M8 - Plain shank special	106	TSA009	Blade wrench